

Soils Map

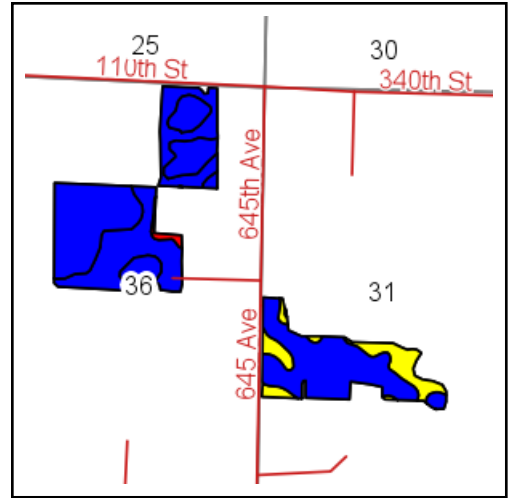

State: **Minnesota**
 County: **East Otter Tail**
 Location: **36-131N-36W**
 Township: **Eastern**
 Acres: **102.2**
 Date: **4/10/2013**

Field borders provided by Farm Service Agency as of 5/21/2008.
Soils data provided by USDA and NRCS.

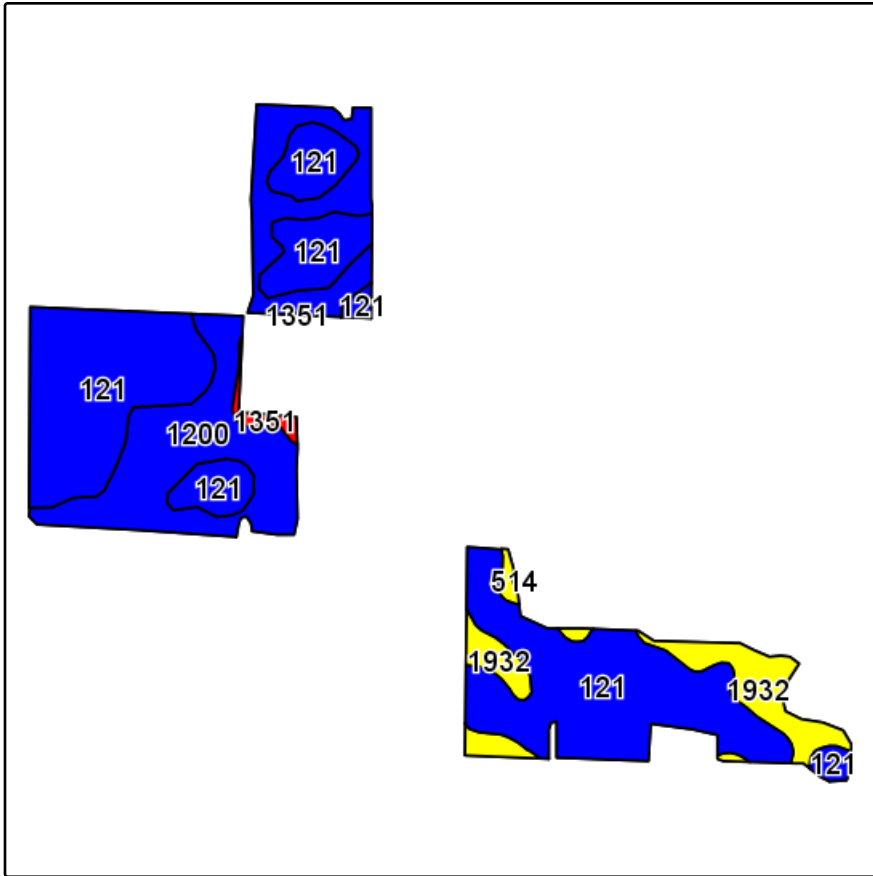
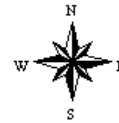

Maps provided by:



Code	Soil Description	Acres	Percent of field	PI Legend	Non-Irr Class	Productivity Index	Alfalfa hay	Barley	Bromegrass alfalfa hay	Canarygrass hay	Corn	Corn silage	Kentucky bluegrass	Oats	Re car
121	Wykeham fine sandy loam	34.1	33.3%		I	87	5.5	75			135	15	3.3	75	
1200	Egglake loam	29.8	29.2%		IIw	81	3	63		4	126	14	4	63	
121	Wykeham fine sandy loam	27	26.5%		I	87	4		5		135	15	3.5	100	
1932	Runeberg sandy loam	10.3	10.1%		IIw	68	3.7		4.5		105	14	6.8	78	
1351	Bluffton loam, moderately permeable	1	0.9%		VIw	15				4.5			3.5		
Weighted Average						82.7	4.1	43.4	1.8	1.2	128.1	14.5	3.9	77.7	