

# Soils Map

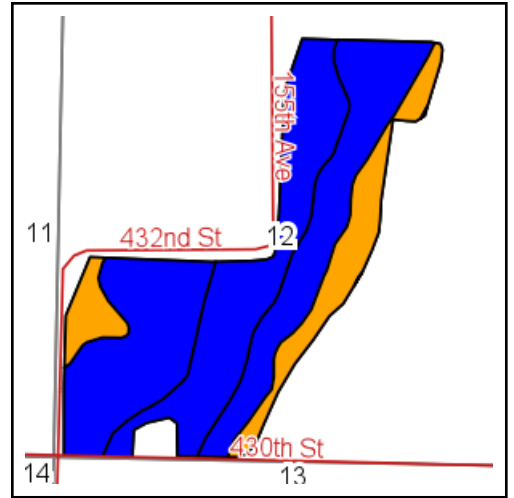

State: **Minnesota**  
 County: **Todd**  
 Location: **12-132N-35W**  
 Township: **Bertha**  
 Acres: **60.9**  
 Date: **4/11/2013**

Field borders provided by Farm Service Agency as of 5/21/2008.  
Soils data provided by USDA and NRCS.

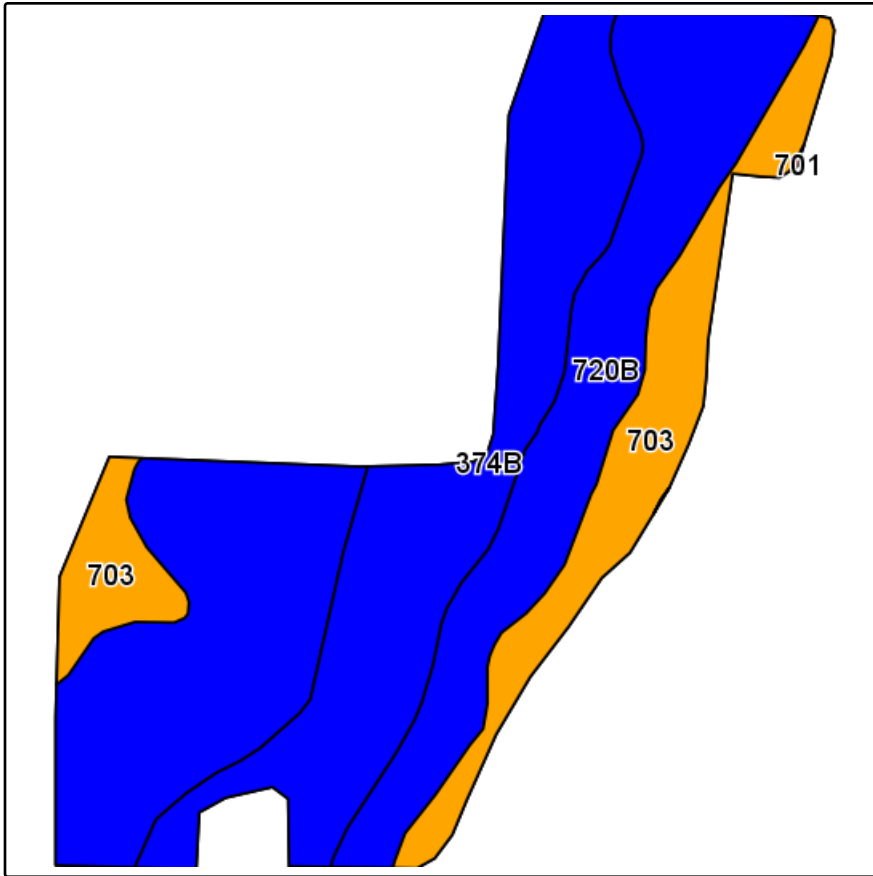

Maps provided by:



©AgriData, Inc 2012  
www.AgriDataInc.com

Code	Soil Description	Acres	Percent of field	PI Legend	Non-Irr Class	Productivity Index	Alfalfa hay	Bromegrass alfalfa hay	Corn	Corn silage	Kentucky bluegrass	Oats	Soybeans	Spring wheat
720B	Blowers sandy loam, 1 to 5 percent slopes	31	50.9%		Ile	87	3.2	4	135	15	3	85	44	43
374B	Rockwood sandy loam, 2 to 6 percent slopes	18.7	30.7%		Ile	85	3.2	4	132	14	3	82	43	42
703	Paddock sandy loam	11.2	18.4%		Ilw	78	2.4	3	121	15	3	77	39	39
<b>Weighted Average</b>						<b>84.7</b>	<b>3.1</b>	<b>3.8</b>	<b>131.5</b>	<b>14.7</b>	<b>3</b>	<b>82.6</b>	<b>42.8</b>	<b>42</b>